



Neuadd Albert | The Albert Hall

Llandrindod | Llandrindod Wells

Pecyn Croeso

Welcome Pack

Wedi'i ddiweddarau: Awst 2024

Updated: August 2024

Table of Contents

Introduction.....	4
Access.....	5
General Terms and Conditions.....	6
Photography and Videography.....	6
Theatre Accommodation.....	7
Dressing Rooms.....	7
Wardrobe and Wig Facilities.....	8
Laundry Facilities.....	8
Kitchen Facilities.....	8
Finding the Theatre.....	9
Address.....	9
What3Words.....	9
Directions.....	9
Parking.....	10
Electric Vehicle Charging.....	10
Fuel.....	11
Overnight Accommodation.....	12
Hotels and Guest Houses:.....	12
Self Catering:.....	12
Local Amenities.....	14
Supermarkets / Shops:.....	14
Restaurants:.....	15
Takeaways:.....	16
Emergency Contacts.....	17
Fire Brigade, Ambulance, Police.....	17
Police (Non-Emergency).....	17
Llandrindod Wells War Memorial Hospital.....	17

Pecyn Croeso | Welcome Pack

A & E Hospital..... 17

Llandrindod Wells Medical Practice..... 17

Pharmacies..... 18

In an Emergency..... 19

Important Fire Safety Regulations..... 19

Introduction

A huge warm welcome to The Albert Hall! We are Mid Wales' Oldest Theatre!

Built in 1896, as a church hall, the theatre at that time was just a large open room. In 1922, with dwindling church attendance, the decision was made to refit the building into a theatre, and was completed in 1923. What you see today, is very much how it was back then – very little has changed! In 1962, the theatre was to be sold, and thankfully saved by a group of townspeople. It was bought for just £2,000 and given to the town as a community resource. Since then, it's been run wholly by volunteers, with no paid staff. Over the years, the hall has suffered from lack of investment, however our current committee took over in March 2020, just as we went into Lockdown, but we have still managed to restore much of the building back to it's former glory! If you're interested in more history, check out our website – <https://thealberthall.co.uk>

We've put together this handy welcome guide, to ensure your visit with us, runs as smoothly as possible, is enjoyable, and is a great success! Being located in Llandrindod Wells, a small rural town, definitely has its benefits, but also a lot of downsides. A lot of the things you would usually expect to find around a theatre, are not present, and we hope this guide will assist you!

For more information, or should you have any queries, please contact The Albert Hall Programming Manager and Technical Manager:

Ben

Email: programming@thealberthall.co.uk / tech@thealberthall.co.uk

Phone: 0300 102 4255 - Option 2 or 6

Web: thealberthall.co.uk/programming/ / thealberthall.co.uk/technical

Please Note: The Albert Hall cannot be held responsible for any costs incurred resulting in information, assumptions or omissions from this document. Please check the availability of equipment, and facilities before planning productions around it. We will endeavour to keep this document up to date, however we cannot guarantee any information found in here to be correct. We also take no responsibility for any content on websites accessed through links in this document.

Access

The Albert Hall has no official loading bay. Access to the stage is via a small alleyway to the left side of the theatre – between the theatre and the church. Therefore, vehicles to be parked at the front of the building for unloading please. Two sets of double doors, open onto the alleyway, one located at the rear of the auditorium, and the other located in the stage right wing area. Level access is available to the auditorium, however all scenery and equipment, will need to be carried up 4 steps onto the stage. There is then an additional 3 into the dressing rooms.

Unfortunately, due to the nature of the building, no backstage areas of the theatre have level, or disabled access.

General Terms and Conditions

- All electrical items brought into the theatre to be used, are to have been PAT tested within the past 12 months.
- Flammable materials such as Straw, Hay, etc, are not to be brought into the building.
- Portable Heaters of any type are banned and are not to be brought into the building.
- No drilling, nailing, screwing, gluing, stapling, or painting shall be undertaken to/in any area within the building or the buildings contents. Only stage weights shall be for affixing to the stage.
- Any electrical items being left unattended should be switched off.
- If any items of equipment, or furniture are moved during the hire, please ensure that they are returned to their original position, at the end.
- You may use a maximum of two trailing leads per wall socket, and no more than one trailing lead should be connected to another.
- No screws, nails, tape, pins, blu-tack, staples, hooks, glue, or similar shall be used to affix any item to the building.
- The following stage effects, and special effects are banned under all circumstances: Pyrotechnics and Fireworks, Spark, Flame, Water and Liquids (including Pistols, Bombs, etc), Snow, Foam, Cream Pies / Flour Bombs / Cake Mix, Fake Blood, Paint (including Spray cans, Touch up pens, aerosols, etc), Stink Bombs, Flying of People, Straw / Hay / Leaves, Silly String.

Photography and Videography

We welcome the use of photography, and videography within our premises on the following conditions:

- No equipment or valuable items are to be shown, to protect the security of the building.
- All persons featured must have given their consent to be filmed or photographed.
- You must comply with any licensing requirements of your production.
- No drones are permitted to be used within, or around the building.

Theatre Accommodation

Dressing Rooms

We have 2 Dressing Rooms with the option to add The Lesser Hall for larger casts.

Dressing Room 1 is recommended for up to 7 cast members, and is located up 3 steps from the stage right wing.

Dressing Room 2, is our larger dressing room, recommended for up to 10 cast members, and is also located up 3 steps from the stage right wing, but can also be accessed from the upstage left wing, up 3 steps, and down a corridor.

The Lesser Hall is suitable for up to 30 people, however this does restrict the use of the Bar. The Lesser Hall is in the basement (-1) and is accessed by a set of stairs to upstage left wing.

Each Dressing Room (Excluding The Lesser Hall) contains:

- Toilet and Sink
- Mirrors
- Chairs
- Surfaces
- Sockets
- Clothes Hooks

The Lesser Hall contains:

- Full Height Mirrors
- Chairs
- Tables
- Sockets

We do not have showers on site.

Wardrobe and Wig Facilities

None on site

Laundry Facilities

None on site, however the nearest is available at:

- [Ascona Texaco – ‘Crossgates’ Service Station](#)

Crossgates, Llandrindod Wells, Powys, LD1 6RE

Opening Times:

Monday to Saturday: 6am to 10pm

Sunday: 7:30am–9pm

- [MFG Texaco – Builth Wells Fuel Station](#)

Station Road, Builth Wells, Powys, LD2 3SS

Opening Times:

Monday to Sunday: 24 Hours

Kitchen Facilities

There is a Small Kitchen located within The Lesser Hall, in the basement (-1) which contains:

- Microwave
- Tea/Coffee making facilities
- Washing up facilities

The kitchen will be used by the Theatre Volunteers from 60 minutes prior to doors, as the Theatre Bar is located adjacent to the kitchen.

We have no on-site catering facilities.

Finding the Theatre

Address

The Albert Hall,
Ithon Road,
Llandrindod Wells,
Powys
LD1 6AS

What3Words

Closes.Modem.Mainland

Directions

From the North:

Follow the A483 into Llandrindod Wells. Continue past the Metropole Hotel on your left. You will come to a mini roundabout with the Automobile Palace (Tom Norton Limited) building ahead to your left. Turn right at the roundabout and head up Spa Road (A4081). Continue past the Commodore Hotel, over the railway bridge. Bear left, until you reach the roundabout. At the roundabout, take the 2nd exit onto Ithon Road, continuing to follow the A4081. The Albert Hall is approximately 50m from the roundabout, on the left.

From the South:

Follow the A483 into Llandrindod Wells. You will see the Automobile Palace (Tom Norton Limited) on your right, turn left at the mini roundabout, and head up Spa Road (A4081). Continue past the Commodore Hotel, over the railway bridge. Bear left, until you reach the roundabout. At the roundabout, take the 2nd exit onto Ithon Road, continuing to follow the A4081. The Albert Hall is approximately 50m from the roundabout, on the left.

From the West:

Follow the A4081 into Llandrindod Wells. Bear right after the river bridge. Continue on this road, past the cemetery, housing estate, and all-weather pitch

on the left. Follow the road around to the left, and up the hill. The Albert Hall is on the right, before you reach the roundabout.

Parking

We cannot guarantee any parking here at The Albert Hall.

There is a small car park adjacent to the theatre, which is owned and used by the local authority offices. If there is a space, you may park there.

On Street Parking is available just up the hill, from the Theatre, however it is limited, and time restricted.

For peace of mind, we recommend you use the [Local Authority Pay and Display Car Park](#), on [High Street \(LD1 6BG\)](#), a short walk away from the theatre.

Please note: The Albert Hall cannot take responsibility for any parking fines or fees, arising from visiting company vehicles, and vehicles are parked at your own risk.

Electric Vehicle Charging

Electric Vehicle (EV) charging is available at:

- The [Local Authority Pay and Display Car Park](#), on [High Street \(LD1 6BG\)](#), a short walk away from the theatre.
 - Powys County Council run this scheme, and more details can be found on their [website](#).

Additional EV charging is available at:

- [The Metropole Hotel & Spa](#)

Temple Street, Llandrindod Wells, Powys, LD1 5DY

- This scheme is run by BP Pulse, and more details can be found on their [website](#).

Fuel

There are 3 petrol stations in the vicinity of Llandrindod Wells:

- [Tesco Petrol Filling Station](#)

Tesco, Waterloo Road, Llandrindod Wells, Powys, LD1 6BG

Opening Times: 24 hours (Pay at Pump) – **Recently the pumps have been closed by 11pm, so we cannot guarantee this is currently operating 24hrs.**

- [Ascona Texaco - 'Ridgebourne' Service Station](#)

Wellington Road, Llandrindod Wells, Powys, LD1 5NB

Opening Times:

Monday to Friday: 6am–10pm

Saturday: 7am–10pm

Sunday: 7am–10pm

- [Ascona Texaco – 'Crossgates' Service Station](#)

Crossgates, Llandrindod Wells, Powys, LD1 6RE

Opening Times:

Monday to Saturday: 6am to 10pm

Sunday: 7:30am–9pm

We would recommend you fuel up prior to your arrival at the theatre, to ensure you will be able to get further home, before needed to fuel.

Further out, there is another couple of 24 hour Garages:

- [Esso Euro Garages – 'The Halt'](#)

A470, Llandrindod Wells, Powys, LD1 6NN

Opening Times:

Open 24 Hours

- [MFG Texaco – Builth Wells Fuel Station](#)

Station Road, Builth Wells, Powys, LD2 3SS

Opening Times:

Open 24 Hours

Overnight Accommodation

We do not have a Digs list here at The Albert Hall, but we have compiled a list of local establishments if you're looking to stay overnight.

Hotels and Guest Houses:

- [The Metropole Hotel & Spa](#)
Temple Street, Llandrindod Wells, Powys, LD1 5DY
- [Highland Moors](#)
Wellington Road, Llandrindod Wells, Powys, LD1 5ND
- [Hampton Hotel](#)
Temple Street, Llandrindod Wells, Powys, LD1 5HF
- [Llanerch Inn](#)
Llanerch Lane, Llandrindod Wells, Powys, LD1 6BZ
- [The Commodore Hotel](#)
Spa Road, Llandrindod Wells, Powys, LD1 5ER
- [The Cottage](#)
Spa Road, Llandrindod Wells, Powys, LD1 5EY
- [Greylands Guesthouse](#)
High Street, Llandrindod Wells, Powys, LD1 6AG
- [Three Wells](#)
Chapel Road, Howey, Llandrindod Wells, Powys, LD1 5PB
- [Acorn Court](#)
Chapel Road, Howey, Llandrindod Wells, Powys, LD1 5PB

Self Catering:

- [Cwm Chwefru Holiday Cottages](#)
Llanafan Fawr, Builth Wells, Powys, LD2 3YG
- [Bryn Thomas Lodges](#)
Penybont, Llandrindod Wells, Powys, LD1 5SW
- [Cwm Yr Hendy Lodges](#)
Penybont, Llandrindod Wells, Powys, LD1 5SU
- [Bluebell Lodge](#)

Pecyn Croeso | Welcome Pack

- Howey, Llandrindod Wells, Powys, LD1 5RH
- [Spring Rock](#)
Llandegley, Llandrindod Wells, Powys, LD1 5UE

Local Amenities

Supermarkets / Shops:

- Tesco Superstore
 - Waterloo Road, Llandrindod Wells, Powys, LD1 6BG
 - Monday to Saturday: 7am – 11pm
 - Sunday: 10am – 4pm
- ALDI
 - Station Crescent, Llandrindod Wells, Powys, LD1 5BB
 - Monday to Saturday: 8am – 10pm
 - Sunday: 10am – 4pm
- SPAR
 - Middleton Street, Llandrindod Wells, Powys, LD1 5BD
 - Monday to Friday: 8am – 5pm
 - Saturday: 8am – 4pm
 - Sunday: Closed
- Hodges News, Food, Wine, and Post Office
 - Tremont Road, Llandrindod Wells, Powys, LD1 5BH
 - Monday to Friday: 6am – 6pm
 - Saturday: 7am – 6pm
 - Sunday: 7.30am – 1pm

Restaurants:

- Zeera, Temple Street, Llandrindod Wells, Powys, LD1 5DL
 - **Indian & Bangladeshi Restaurant / Takeaway**
 - Monday to Thursday: 5pm – 11pm
 - Friday & Saturday: 5pm – 11.30pm
 - Sunday: 5pm – 10.30pm
- Fabian's Kitchen, Temple Street, Llandrindod Wells, Powys, LD1 5DP
<https://www.fabianskitchen.co.uk/>
 - **Burgers, Pizzas, & Curry Restaurant / Takeaway**
 - Monday to Sunday: 5pm – 9.30pm
- Gino's Pizzeria, Park Terrace, Llandrindod Wells, Powys, LD1 6AB
<https://www.facebook.com/GinosLlandod/>
 - **Pizza Restaurant**
 - Monday & Tuesday: Closed
 - Wednesday & Thursday: 4.30pm – 9pm
 - Friday & Saturday: 4.30pm – 10pm
 - Sunday: 4.30pm – 9pm
- Llanerch Inn, Llanerch Ln, Llandrindod Wells LD1 6BZ
<https://www.llanerchinn.com/restaurant>
 - **Pub**
 - Monday to Saturday: 12pm – 9pm
 - Sunday: 5pm – 8pm
- Temple Bar, Fiveways, Temple Street, Llandrindod Wells, Powys, LD1 5HG
<https://www.facebook.com/TempleBarLlandrindod>
 - **Pub**
 - Monday & Tuesday: 3pm – 10pm
 - Wednesday & Thursday: 12pm – 11pm
 - Friday & Saturday: 12pm – 11.30pm
 - Sunday: 12pm – 9pm
- The Metropole Hotel, Temple Street, Llandrindod Wells, Powys, LD1 5DY
<https://www.metropole.co.uk/>
 - **Hotel with Restaurant / Brasserie**

Takeaways:

- Golden Rice Bowl, Park Terrace, Llandrindod Wells, Powys, LD1 6AB
 - **Chinese Takeaway**
 - Monday: Closed
 - Tuesday to Sunday: 5pm – 11pm
- Lip Lickin' Kebab House, Park Terrace, Llandrindod Wells, Powys, LD1 6AB
 - **Burgers, Kebabs, and Pizza Takeaway**
 - Monday to Saturday: 12pm – 11pm
 - Sunday: 2pm – 11pm
- Zeera, Temple Street, Llandrindod Wells, Powys, LD1 5DL
 - **Indian & Bangladeshi Restaurant / Takeaway**
 - Monday to Thursday: 5pm – 11pm
 - Friday & Saturday: 5pm – 11.30pm
 - Sunday: 5pm – 10.30pm
- Fabian's Kitchen, Temple Street, Llandrindod Wells, Powys, LD1 5DP
<https://www.fabianskitchen.co.uk/>
 - **Burgers, Pizzas, & Curry Restaurant / Takeaway**
 - Monday to Sunday: 5pm – 9.30pm
- The Fish Bar, High Street, Llandrindod Wells, Powys, LD1 6AG
 - **Fish and Chips Takeaway**
 - Monday to Saturday: 11:30am – 2pm & 4:30pm – 9:30pm
 - Sunday: Closed
- The Quality Fish Bar, Waterloo Road, Llandrindod Wells, Powys, LD1 6BL
 - **Fish and Chips Takeaway**
 - Monday to Saturday: 11:30am – 2:30pm & 4:30pm – 10 pm
 - Sunday: 4.30pm – 9.30pm

PLEASE NOTE:

If you bring food back to The Albert Hall to eat, please try and use the Lesser Hall to eat. **Hot food is not permitted in the auditorium**, and we like to keep the consumption of food in the dressing rooms to a minimum. You are free to use the Lesser Hall for eating hot food.

Emergency Contacts

Fire Brigade, Ambulance, Police

999

Police (Non-Emergency)

101

Llandrindod Wells War Memorial Hospital

Llandrindod Wells Memorial Hospital is a local community hospital with a Minor Injury Unit open 7am – 12am, 7 days a week.

01597 822951

Temple Street, Llandrindod Wells, Powys, LD1 5HF

A & E Hospital

The County Hospital – Hereford

Open 24 hours

01432 355444

Stonebow Road, Hereford, Herefordshire, HR1 2BN

Llandrindod Wells Medical Practice

Monday to Friday: 8am – 6.30pm

Saturday & Sunday: Closed

The Surgery, Spa Road East, Llandrindod Wells, Powys, LD1 5ES

If you need care that cannot wait until the surgery is open, please ring **111** which is a free number. If phoning from a mobile you may be unable to connect to this number – you will then need to phone **0345 46 47** instead.

Telephone advice on a range of medical conditions is available from NHS Direct 24 hours a day. Their number is **111**.

Pharmacies

- Lakeside Pharmacy
Princes Avenue, Llandrindod Wells, Powys, LD1 5HU
 - 01597 822174
 - Monday to Friday: 8.30am – 5.30pm
 - Saturday: 9am – 1pm
 - Sunday: Closed
- Boots
Station Crescent, Llandrindod Wells, Powys, LD1 5BB
 - 01597 822311
 - Monday to Friday: 8.30am – 5.30pm
 - Saturday: 8.30am – 5pm
 - Sunday: Closed

In an Emergency

You should appoint a 'Company Manager' who will be responsible for ensuring all of your company can be accounted for, in the event of an evacuation.

There is no automatic fire alarm at The Albert Hall.

In the event of discovering a fire, you should:

- Sound the alarm by activating the nearest 'Air Horn'
- Evacuate the building by the nearest fire exit
- Report to the venue fire manager, at the front of the building
- Wait in the assembly point: Car Park to right hand side of the building.

You should NOT:

- Take Risks
- Re-enter the building until it is safe to do so

In the event of hearing an Air Horn, you should:

- Evacuate the building by the nearest fire exit
- Report to the venue fire manager, at the front of the building
- Wait in the assembly point: Car Park to right hand side of the building.

Important Fire Safety Regulations

The Albert Hall, and it's hirers must obey by these rules at all times:

- No Heaters of any type are to be brought into the building
- All Electrical Equipment must be PAT Tested
- No Fire Exit Routes, or Doorways are to be blocked

Further details can be found in our [Hiring Terms](#)

Appendix

Appendix A: Stage Plan

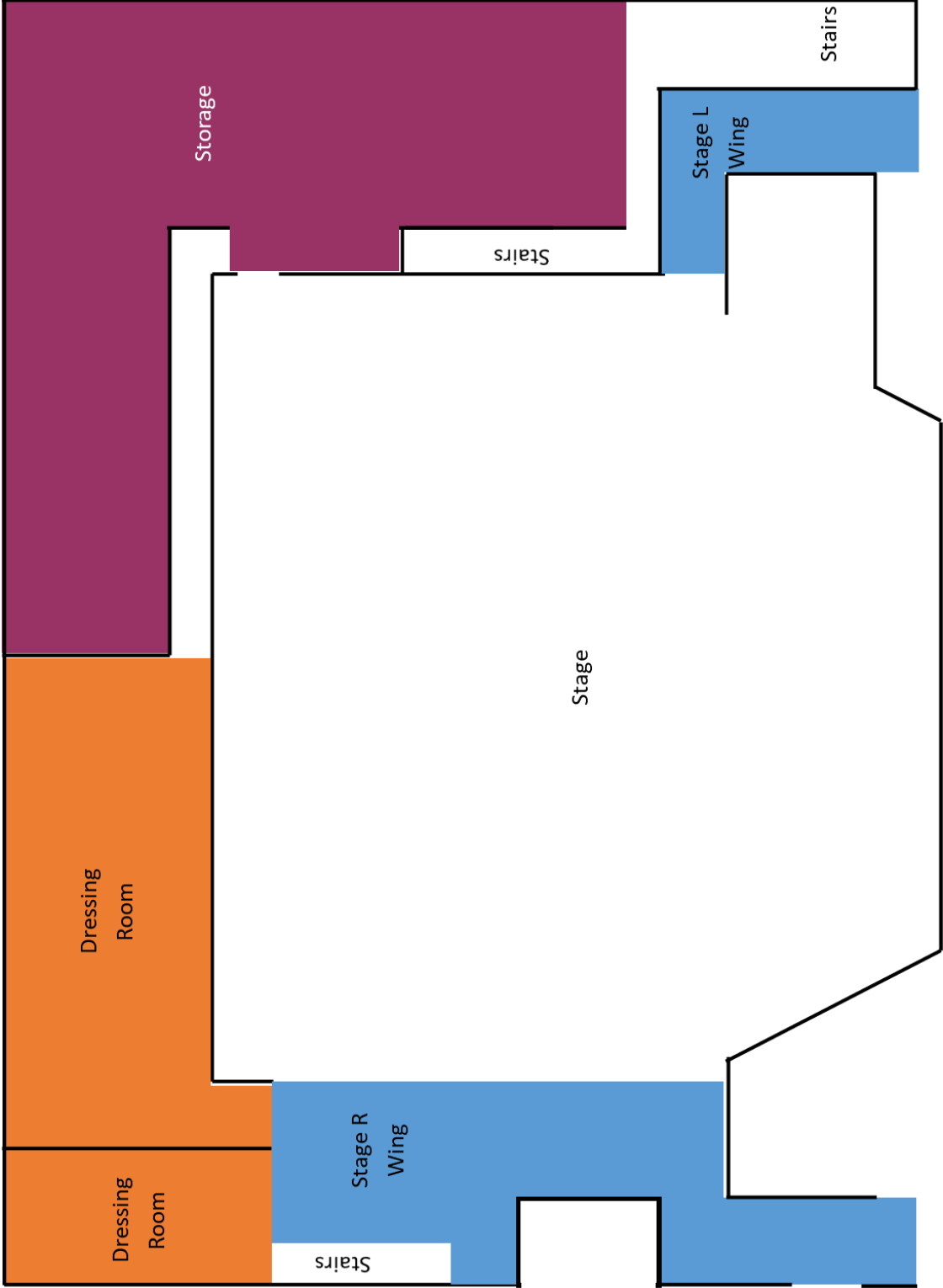

Not to Scale – Rough Plan