

Llandrindod | Llandrindod Wells

# Manylebau Technegol

## Technical Specifications

Wedi'i ddiweddarau: Ebrill 2024

Updated: April 2024

## Contents:

CONTENTS:.....	2
INTRODUCTION .....	3
SEATING CAPACITY.....	4
ACCESS.....	5
STAGE INFORMATION AND DIMENSIONS.....	6
FLYING SYSTEM.....	8
DRAPERY (CURTAINS).....	8
STAGE MANAGEMENT FACILITIES .....	9
STAGE POWER.....	10
ACCOMMODATION .....	11
LIGHTING.....	13
SOUND.....	16
BAND FACILITIES.....	17
COMMS (CANS).....	17
RELAY SYSTEM: .....	17
RIGGING.....	18
FINDING THE THEATRE .....	19
APPENDIX .....	20

## Introduction

The following document outlines the technical specifications and plans for the Albert Hall Theatre, Llandrindod Wells. The Albert Hall Management Committee does not guarantee that all or any of these facilities or equipment will be available or suitable for the purposes of the visiting company. A visiting company should in all cases, check with The Albert Hall's Programming Manager to ensure this information is up to date and correct. At certain times some equipment detailed in this document may be temporarily unavailable.

For more information, or should you have any queries, please contact The Albert Hall Programming Manager and Technical Manager:

### **Ben Williams**

**Email:** [programming@thealberthall.co.uk](mailto:programming@thealberthall.co.uk) / [technical@thealberthall.co.uk](mailto:technical@thealberthall.co.uk)

**Phone:** 0300 102 4255 - Option 2 or 6

**Web:** <https://thealberthall.co.uk/programming/>  
<https://thealberthall.co.uk/technical>

**Please Note:** The Albert Hall cannot be held responsible for any costs incurred resulting in information, assumptions or omissions from this document. It is the responsibility of the visiting company to check critical dimensions, in person, before commissioning scenery. Please check the availability of equipment, and facilities before planning productions around it.

## Seating Capacity

Stalls	241
Circle	211
Wheelchair Spaces	4
<b>Total</b>	<b>456</b>
Kills (Tech Desk)	-5
<b>Total Sellable</b>	<b>451</b>

If you require seats to be held off sale, you must notify us as far in advance as possible. We may not be able to hold seats once they are on sale.

(See Appendix A for the Seating Plan).

## Access

The Albert Hall has no official loading bay. Access to the stage is via a small alleyway to the left side of the theatre – between the theatre and the church. Therefore, vehicles are to be parked at the front of the building for unloading please. Two sets of double doors, open onto the alleyway, one located at the rear of the auditorium, and the other located in the stage right wing area. Level access is available to the auditorium, however all scenery and equipment, will need to be carried up 4 steps onto the stage. There is then an additional 3 steps into the dressing rooms.

Unfortunately, due to the nature of the building, no backstage areas of the theatre have level, or disabled access.

## Parking

We cannot guarantee any parking here at The Albert Hall.

There is a small car park adjacent to the theatre, which is owned and used by the local authority offices. If there is a space, you may park there.

On Street Parking is available just up the hill, from the Theatre, however it is limited, and time restricted.

For peace of mind, we recommend you use the [Local Authority Pay and Display Car Park](#), on [High Street \(LD1 6BG\)](#), a short walk away from the theatre.

**Please note:** The Albert Hall cannot take responsibility for any parking fines or fees, arising from visiting company vehicles, and vehicles are parked at your own risk.

## Stage Information and Dimensions

### Stage

**Type of Stage:** Proscenium

**Rake:** No

**Surface:** Black MDF

**Stage Fixing:** No drilling or fixing allowed. Stage weights only.

### Proscenium

**Size of Proscenium:**

**Maximum Width:** 7.68m

**Depth (Front of Proscenium to Setting Line):** 0.65m

**Height:** 5.00m

**Height to bottom of Red Pelmet (Non Removable):** 4.24m

### Apron

**Size of Apron:**

**US Maximum Width:** 9.34m

**DS Maximum Width:** 4.93m

**Depth:** 1.85m

**Height of Apron from House Floor:** 1.00m

### Setting Line

**Setting line to front of proscenium:** 0.65m

**Setting line to front edge of stage:** 2.50m

**Setting line to rear wall:** Maximum of 5.21m

### Height

**Height of Grid:** 5m

**Wing Height:** 2.4m

## Traps

**Traps:** None

## Stage Access

Access to stage is down an external alleyway on Stage R.

**Width of alleyway:** 0.985m

**Double door access:** 1.5m wide by 2m high

The stage is then 4 steps up from the alleyway.

There is no loading bay, or dock. Vans to be parked outside the front doors, and equipment, set, etc, brought in through the alleyway.

## Backstage Layout and Stage Plan:

See Appendix B for Backstage Layout, and the Stage Plan can be found on the [Technical Page](#) on our website.

## Flying System

**Flying Type:** 4 x Manually Hauled Hemp Sets (1 Additional, but not presently useable)

**Weight Limit:** 50kg per Hemp Set – Uniformly distributed.

**Barrel (pipe) diameter:** 50mm

**Barrel length:** 7.2m

**Spacing between sets:** TBC

**Please Note:** We do not have the ability to fly persons on our rigging.

## Drapery (Curtains)

### House Tabs

Manually Operated (Stage L)

Red - horizontally opening tabs – FIXED (not available to be taken down)

### Secondary Tabs

Manually Operated (Stage R)

Black – horizontally opening tabs – FIXED (not available to be taken down)

### Cyclorama (Cyc.)

Black flown on HS1 as standard – Can be removed for another drape, or moved onto another hemp set.

### Masking

HS3: Black Border (1.2m drop) & Black Legs (1.4m width) as standard - Can be removed, or moved onto other hemp sets.

### Additional Drapes Available (Upon Request)

- 1 x White Cyclorama (4m drop)
- 2 x Black Legs (1.4m width)



- 1 x Black Border (1.2m drop)
- 2 x White Voiles (1m width)
- 1 x The Albert Hall Banner (5m drop x 2m width) – **Limited Use Only**

## Stage Equipment Available:

- 10 x 12.5kg Stage Weights
- Various Clamps
- Curtain Clips and Ties

## Stage Management Facilities

**Prompt corner position:** No Set Position

**FOH call facilities:** Duty Technician will be in contact with both FOH on radio, and Backstage/Tech crew on Comms

**Cue-Lights:** None

**Bar Bells:** None

**First Aid Box:** Stage Right

## Stage Power

### Upstage Right

- 2 x Double 240V 13A Sockets

### Upstage Left

- 2 x Double 240V 13A Sockets

### Downstage Left

- 1 x Double 240V 13A Sockets

### Downstage Right

- 2 x Double 240V 13A Sockets
- 2 x 63A Sockets

### Additional Power Options

- Multiple Extension Cables available upon request
- 2 x 13A to 16A Convertors
- Limited 13A to 15A (Lighting – Round Pin) Convertors

## Accommodation

### Dressing Rooms

2 Dressing Rooms with the option to add [The Lesser Hall](#) for larger casts.

Dressing Room 1 is recommended for up to 7 cast members, and is located up 3 steps from the stage right wing. Dressing Room 2, is our larger dressing room, recommended for up to 10 cast members, and is also located up 3 steps from the stage right wing, but can also be accessed from the upstage left wing, up 3 steps, and down a corridor. The Lesser Hall is suitable for up to 30 people, however this does restrict the use of the Bar. The Lesser Hall is in the basement (-1) and is accessed by a set of stairs to upstage left wing.

Each Dressing Room (Excluding The Lesser Hall) contains:

- Toilet and Sink
- Mirrors
- Chairs
- Surfaces
- Sockets
- Clothes Hooks

The Lesser Hall contains:

- Full Height Mirrors
- Chairs
- Tables
- Sockets

We do not have showers on site.

For pictures of the Dressing Rooms, please see Appendix C

### Wardrobe and Wig Facilities

None on site

## Laundry Facilities

None on site, however the nearest is available at:

- [Ascona Texaco – ‘Crossgates’ Service Station](#)

Crossgates, Llandrindod Wells, Powys, LD1 6RE

### **Opening Times:**

Monday to Saturday: 6am to 10pm

Sunday: 7:30am–9pm

- [MFG Texaco – Builth Wells Fuel Station](#)

Station Road, Builth Wells, Powys, LD2 3SS

### **Opening Times:**

Monday to Sunday: 24 Hours

## Kitchen Facilities:

There is a Small Kitchen located within The Lesser Hall, in the basement (-1) which contains:

- Microwave
- Tea/Coffee making facilities
- Washing up facilities

## Lighting

The Albert Hall now runs a complete rig of LED Lighting Fixtures. Therefore, we no longer have dimming facilities, so if you wish to bring an old style fixture, you will also need to bring a Dimmer Pack which will accept a DMX Feed.

As all lighting is either RGB, RGBW, or RGBAL, we no longer keep stock of any Gels and do not have capability to put any Gels into the fixtures. The colour mixing of the LEDs allows us to generate the colours you require.

**The Albert Hall's Lighting System is now only to be used by our Technicians, paid at the rate specified in the [Scale of Charges](#).**

### Lanterns in fixed rig:

#### FOH Follow Spot Perch (Each Side):

- 2 x Zoom Profile Spots
- 1 x Moving Head Hybrid
- 1 x Gobo Zoom Profile Spot (**Fitted and Focussed with venue logo gobo**)

#### FOH Booms (Each Side):

- 1 x Junior Zoom Profile Spot
- 1 x Moving Head Hybrid
- 2 x Zoom Profile Spots

#### Overhead LX1:

- 4 x Zoom Fresnel
- 4 x Zoom Par Can
- 2 x Moving Head Zoom Wash

#### Overhead LX2:

- 2 x Zoom Fresnel
- 2 x Zoom Par Can
- 4 x Moving Head Hybrid

## Overhead LX3:

- 2 x Zoom Fresnel
- 4 x Cyc Lighters

## Followspots:

- 2 x LEDJ FS300 LED Followspot (Located on Followspot Perches in the Circle)

## Additional Fixtures and Special Effects:

We have the following additional fixtures and special effects available. Advanced notification is required as we will need to collect these from our stores, and bring to the venue.

- 2 x Moving Head Hybrid
- 6 x RGBW Par Cans
- 2 x Moving Head Zoom Wash
- 4 x RGB Batten
- 1 x LED Strobe
- 2 x UV Fluorescents
- 2 x Hazers

Further Fixtures and Effects (inc. Confetti Cannons, and Bubble Effects) are available from our friends at BRGW Technical – [brgw.co.uk](http://brgw.co.uk)

## Rigging Equipment:

- 1 x Zarges (**TAH Use Only**)
- 1 x 2 Piece Ladder
- 1 x Mini Step Ladder

## Control:

We have a Digital Desk with 8 universe capability (Fixed Rig runs on 3 universes) which will be operated by our Technicians, either from the Tech Booth or Work Station at rear of Stalls.

## House Lights:

Our LED house lights are operated either by a manual fader panel in the Tech Booth, or by DMX through our lighting desk.

## Lighting Power

The lighting rig is powered separately to the other sockets around the stage. We also have capability to provide 15A hot power (non-dimmable) to downstage right. This can be used for lighting fixtures or special effects of your own, if required.

**Please Note:** Items are plugged into our lighting system at your own risk. We cannot be held responsible for any damage or malfunction caused to your equipment.

## Lighting Documents:

Additional lighting documents can be found on our website, on the page where you found this document.

## Sound

We ask that for commercial touring productions, you bring your own PA system, and Engineers, as they know your show, and the requirements for it.

**PLEASE NOTE:** Our in-house Sound System is only to be used by our technicians.

### Speakers:

- 4 x 15" Active Top Cabs
- 2 x 15" Active Bass Bins
- 2 x 8" Active Top Cabs, as fills for rear alcoves.

### Control:

For control, we have Digital Desk (48 Channel) with CAT6 Stage Box (16 In / 8 Out) which is located on the work station at rear of Stalls.

### Additional Equipment:

We have additional sound equipment available, however advanced Notification is required as we will need to collect these from our stores, and bring to the theatre.

- 1 x Additional CAT 6 Stage Box (16 In / 8 Out)
- 4 x 12" Active Monitor Speakers
- 1 x 15m 8 way Analogue Multicore
- 1 x CD/USB Player
- 8 x Wireless Headset (or 6 Lapel) Microphones – Additional charge applies
- 2 x Wireless Handheld Microphones – Additional charge applies
- 4 x Wired Handheld Microphones
- 4 x Boundary Microphones
- Multiple boom microphone stands



## Band Facilities

**Pit Size:** Variable – MAX: 4m x 1.8m

**Band Rooms:** None specifically – If you need dedicated accommodation, then you could use a dressing room, or The Lesser Hall

**Music Stands:** None

**Chairs:** approx. 30

## Comms (Cans)

### Equipment:

Comms unit with 5 belt pack devices

### Location:

**Main Unit:** Stage right wing area (Headset for stage manager)

**Belt packs:** 2 in Tech Booth, 1 stage left wing area, 1 each for follow spots.

(These are not fixed, and can be moved around if necessary)

## Relay System:

There is an Active 4" Speaker in both of the Dressing Rooms, which can be fed show mix from the sound desk. **NOT CURRENTLY SET UP**

There is also a speaker system in the Lesser Hall, which can also be fed the show mix, from the sound desk. **NOT CURRENTLY SET UP**

## Rigging

As taken from the Terms and Conditions of Hiring:

**No rigging, or de-rigging** is to take place onto any of The Albert Hall rig without prior authorisation of the Chairperson, or Technical Manager. Any rigging that takes place, will need to be done in accordance with the ABTT's Technical Standards for Places of Entertainment, with the Chairperson, or Technical Manager present. Should any rigging take place without prior authorisation, without the above person/s present, or if it does not comply with the standards, The Albert Hall reserves the right to remove the rigged items, make adjustments to rigged items, or postpone a booking until the matters are resolved. Any costs incurred, will be the responsibility of the hirer.

## Finding the Theatre

### Address:

The Albert Hall,  
Ithon Road,  
Llandrindod Wells,  
Powys  
LD1 6AS

**What3Words:** Closes.Modem.Mainland

### Directions:

#### From the North:

Follow the A483 into Llandrindod Wells. Continue past the Metropole Hotel on your left. You will come to a mini roundabout with the Automobile Palace (Tom Norton Limited) building ahead to your left. Turn right at the roundabout and head up Spa Road (A4081). Continue past the Commodore Hotel, over the railway bridge. Bear left, until you reach the roundabout. At the roundabout, take the 2nd exit onto Ithon Road, continuing to follow the A4081. The Albert Hall is approximately 50m from the roundabout, on the left.

#### From the South:

Follow the A483 into Llandrindod Wells. You will see the Automobile Palace (Tom Norton Limited) on your right, turn left at the mini roundabout, and head up Spa Road (A4081). Continue past the Commodore Hotel, over the railway bridge. Bear left, until you reach the roundabout. At the roundabout, take the 2nd exit onto Ithon Road, continuing to follow the A4081. The Albert Hall is approximately 50m from the roundabout, on the left.

#### From the West:

Follow the A4081 into Llandrindod Wells. Bear right after the river bridge. Continue on this road, past the cemetery, housing estate, and all-weather pitch on the left. Follow the road around to the left, and up the hill. The Albert Hall is on the right, before you reach the roundabout.

## Appendix

### Appendix A:

Seating Plan – PDF available on our [Technical page](#).

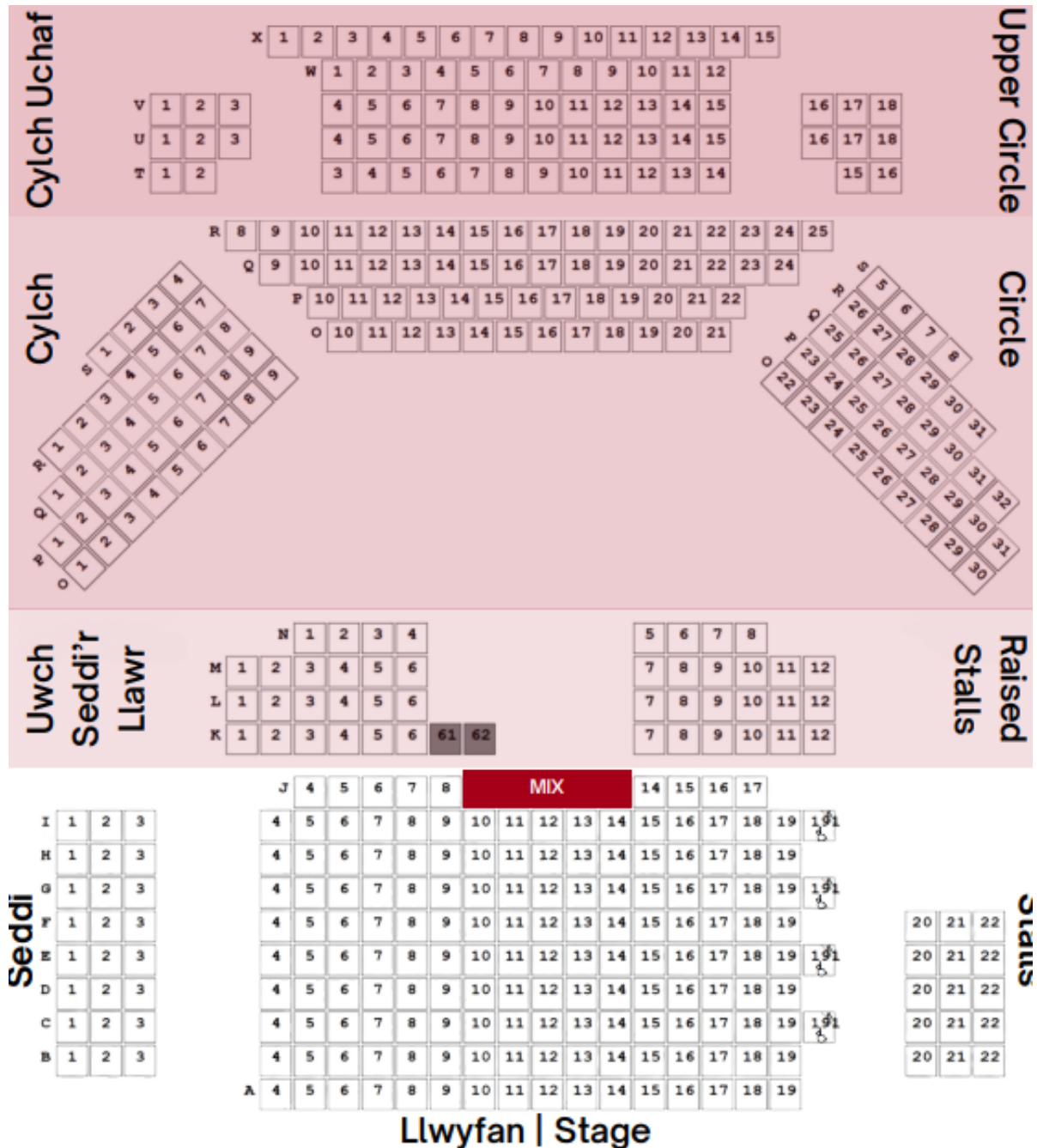

**Llawr Gwaelod | Ground Floor (242) - Seddi | Stalls: 192 Uwch Seddi'r Llwr | Raised Stalls: 44**  
 Mainc | Pew: 2 (K61/62) Gofod Cadair Olwyn | Wheelchair Spaces: 4  
**Llawr Cyntaf | First Floor (211) - Cylch | Circle: 132 Cylch Uchaf | Upper Circle: 79**

**Note:** K61 & K62 is a Church Pew style bench, usually not sold, and instead used as our 2 House Seats. C191, E191, G191, H191 are allocated Wheelchair spaces. These are in the alleyway, so could potentially also go the other side of the walkway, next to seat 20.

Appendix B:  
Backstage Layout Plan

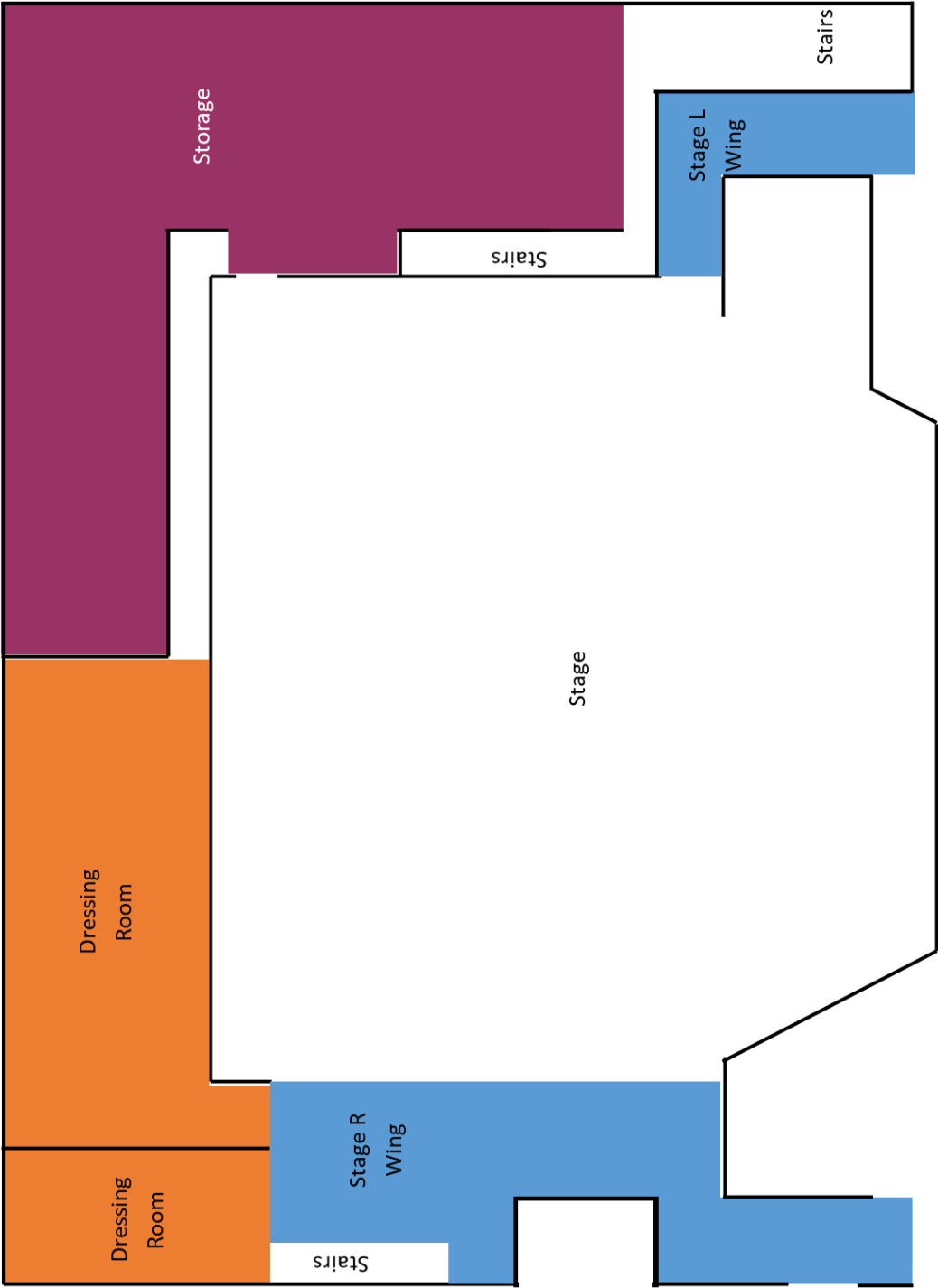

Not to Scale

This is a basic plan to show the layout of the backstage area of the building, For a detailed stage plan, with measurements, please see our Stage Plan found on our [Technical Page](#).

Appendix C: Dressing Room Pictures



Dressing Room 1



Dressing Room 2



Lesser Hall (can be added for larger casts)