

Manylebau Technegol

Technical Specifications

Wedi'i ddiweddarau: Tachwedd 2021

Updated: November 2021

Manylebau Technegol | Technical Specifications

Manylebau Technegol | Technical Specifications

Contents:	Page:
Introduction	3
Seating Capacity	4
Access	4
Stage Details	5
Flying System	6
Curtains	6
Stage Management Facilities	7
Stage Power	7
Accommodation	7
Lighting	8
Sound	9
Comms (Cans)	10
Band Facilities	10
Finding the Theatre	11
Appendix	
Appendix A: Seating Plan	12
Appendix B: Stage Plan	13
Appendix C: Dressing Room Pictures	14

Manylebau Technegol | Technical Specifications

Introduction

The following document outlines the technical specifications and plans for the Albert Hall Theatre, Llandrindod Wells. The Albert Hall Management Committee does not guarantee that all or any of these facilities or equipment will be available or suitable for the purposes of the visiting company. A visiting company should in all cases, check with the Albert Hall Booking Secretary to ensure this information is up to date and correct. At certain times some equipment detailed in this document may be temporarily unavailable.

For more information, or should you have any queries, please contact the Albert Hall Booking Secretary and Technical Manager:

Ben Williams

Email: booking@thealberthall.co.uk / tech@thealberthall.co.uk

Phone: 0300 102 4255 - Option 2 or 6

Web: <https://thealberthall.co.uk/booking> / <https://thealberthall.co.uk/technical>

Please Note: The Albert Hall cannot be held responsible for any costs incurred resulting in information, assumptions or omissions from this document. It is the responsibility of the visiting company to check critical dimensions, in person, before commissioning scenery. Please check the availability of equipment, and facilities before planning productions around it.

Seating Capacity

Stalls	241
Circle	211
Wheelchair Spaces	4
Pew (Bench)	2
Total	458

If you require seats to be held off sale, you must notify us as far in advance as possible. We may not be able to hold seats once they are on sale.

(See Appendix A for the Seating Plan).

Access

The Albert Hall has no official loading bay. Access to the stage is via a small alleyway to the left side of the theatre – between the theatre and the church. Two sets of double doors, open onto the alleyway, one located at the rear of the auditorium, and the other located in the stage right wing area. Level access is available to the auditorium, however all scenery and equipment, will need to be carried up 4 steps onto the stage.

We are unable to provide parking at the Theatre, but we will try our best to accommodate you. Alternatively, you can apply to the local council for a parking dispensation, to allow you to park directly outside the theatre. **Please note:** The Albert Hall cannot take responsibility for any parking fines or fees, arising from visiting company vehicles, and vehicles are parked at your own risk.

Unfortunately, due to the nature of the building, no backstage areas of the theatre have level, or disabled access.

Stage Information and Dimensions

Type of Stage: Proscenium

Rake: No

Surface: Black MDF

Stage Fixing: No drilling or fixing allowed. Stage weights only.

Size of Proscenium:

Width: 8m

Height: 5m

Size of Apron:

Width: 5m

Depth: 2m

Setting line to rear of proscenium: 0.5m

Setting line to front edge of stage: 2.5m

Setting line to rear wall: 5.85m

Height of Grid: 5m

Wing Space:

Stage left: 2m x 1.4m **Height:** 2.4m

Stage right: 3m x 2.5m **Height:** 2.4m

Traps: None

Stage Access:

Access to stage down Stage R alleyway.

Width of alleyway: 0.985m

Double door access: 1.5m wide by 2m high

Stage Plan:

See Appendix B

Flying System

Total number of lines: 4

Barrel (pipe) diameter: 5cm

Barrel length: 7.2m

Spacing between lines:



Distance from line 4 to rear of proscenium: 1.2m

Curtains

House Tabs: Red (Horizontal opening)

Cyclorama (Cyc.): Black - White available upon request

Blacks:

Borders: 3

Legs: 2

Tabs: 1 set of Yellows (Horizontal opening)

Stage Management Facilities

Prompt corner position: Where required

FOH call facilities: None

Cue-Lights: None

Bar Bells: None

First Aid Box: Multiple

Stage Power

Stage Left: Single 240V/13A Socket downstage.

Stage Right: Single 240V/13A Socket downstage. Double 240V/13A socket located under the new Apron Extension.

Single 240V/63A Socket is available if a Dimmer Pack is dropped out. You will need your own adapter, as we do not have one.

Accommodation

Dressing Rooms: 2 with option to add [Lesser Hall](#) for larger casts

Dressing Room Facilities: Toilet and sink in the 2 dressing rooms, all equipped with mirrors, chairs, surfaces, and sockets.

Showers: None

Access to Stage: Direct access from both dressing rooms. Lesser Hall is situated 1 level lower.

Wardrobe Facilities: None

Wig Facilities: None

Laundry Facilities: None

For pictures, see Appendix C

Manylebau Technegol | Technical Specifications

Lighting

Number of Dimmers: 29 (27 available for twinning) – One bank of 6 to be dropped out for 240V/63A supply if required.

Dimmer Rating: 10amps each

Tungsten Lanterns in fixed rig:

Profiles, Pars, and Fresnels: 38

Followspots: 2 located FOH above Circle

LED Lanterns in fixed rig:

4 x LED RGBW Cyc Lighters

Rigging Equipment:

A Frame Ladder, Ladder, Step Ladder

Control:

Strand 200 – 48 Channel

Zero 88 Fat Frog - 48 Channel

We do have a digital desk available, however this is only to be used by our technician, and is not kept on site.

Control Location: Tech Booth or Work Station at rear of Stalls

House Lights:

Switch located stage right, dimming controlled from Lighting Box

Lighting Documents:

Lighting plots, and socket plans are available to download from the technical page of our website, where you found this document.

Sound

Speakers:

4 x Wharfedale Titan 15, powered by single amp

Mixer:

Soundcraft Spirit FX 8 – 8-10 channel

Control Location:

Tech Booth or Work Station at rear of Stalls

Additional Equipment:

2 HH Electronics VRM-12A Active Monitor Speakers

Allen and Heath GL2200 – 16 Channel Analogue Mixer

CD Player

8 Wireless Headset Microphones – Additional charge applies

2 Wireless Handheld Microphones

Multiple boom microphone stands

Please Note – The above equipment is not kept on site, and therefore, we require at least one week's notice to ensure we have it at the building ready for your use.

Manylebau Technegol | Technical Specifications

Band Facilities

Pit Size: Variable – MAX: 4m x 1.8m

Band Rooms: None specifically – potentially use a dressing room, or lesser hall

Equipment available:

Music Stands: None

Chairs: approx. 50

Rostra: Possibly – please enquire at least one month prior to booking

Comms (Cans)

Equipment:

Comms unit with 5 belt pack devices

Location:

Main Unit: Stage right wing area (Headset for stage manager)

Belt packs: 1 in Tech Booth, 1 stage left wing area, 1 each for follow spots, and 1 in orchestra pit.

Rigging

As taken from the Terms and Conditions of Hiring:

No rigging, or de-rigging is to take place onto any of The Albert Hall rig without prior authorisation of the Chairperson, or Technical Manager. Any rigging that takes place, will need to be done in accordance with the ABTT's Technical Standards for Places of Entertainment, with the Chairperson, or Technical Manager present. Should any rigging take place without prior authorisation, without the above person/s present, or if it does not comply with the standards, The Albert Hall reserves the right to remove the rigged items, make adjustments to rigged items, or postpone a booking until the matters are resolved. Any costs incurred, will be the responsibility of the hirer.

Finding the Theatre

Address:

The Albert Hall Theatre,
Ithon Road,
Llandrindod Wells,
Powys
LD1 6AS

What3Words: Closes.Modem.Mainland

Directions:

From the North:

Follow the A483 into Llandrindod Wells. Continue past the Metropole Hotel on your left. You will come to a mini roundabout with the Automobile Palace (Tom Norton Limited) building ahead to your left. Turn right at the roundabout and head up Spa Road (A4081). Continue past the Commodore Hotel, over the railway bridge. Bear left, until you reach the roundabout. At the roundabout, take the 2nd exit onto Ithon Road, continuing to follow the A4081. The Albert Hall is approximately 50m from the roundabout, on the left.

From the South:

Follow the A483 into Llandrindod Wells. You will see the Automobile Palace (Tom Norton Limited) on your right, turn left at the mini roundabout, and head up Spa Road (A4081). Continue past the Commodore Hotel, over the railway bridge. Bear left, until you reach the roundabout. At the roundabout, take the 2nd exit onto Ithon Road, continuing to follow the A4081. The Albert Hall is approximately 50m from the roundabout, on the left.

From the West:

Follow the A4081 into Llandrindod Wells. Bear right after the river bridge. Continue on this road, past the cemetery, housing estate, and all-weather pitch on the left. Follow the road around to the left, and up the hill. The Albert Hall is on the right, before you reach the roundabout.

Appendix

Appendix A: Seating Plan

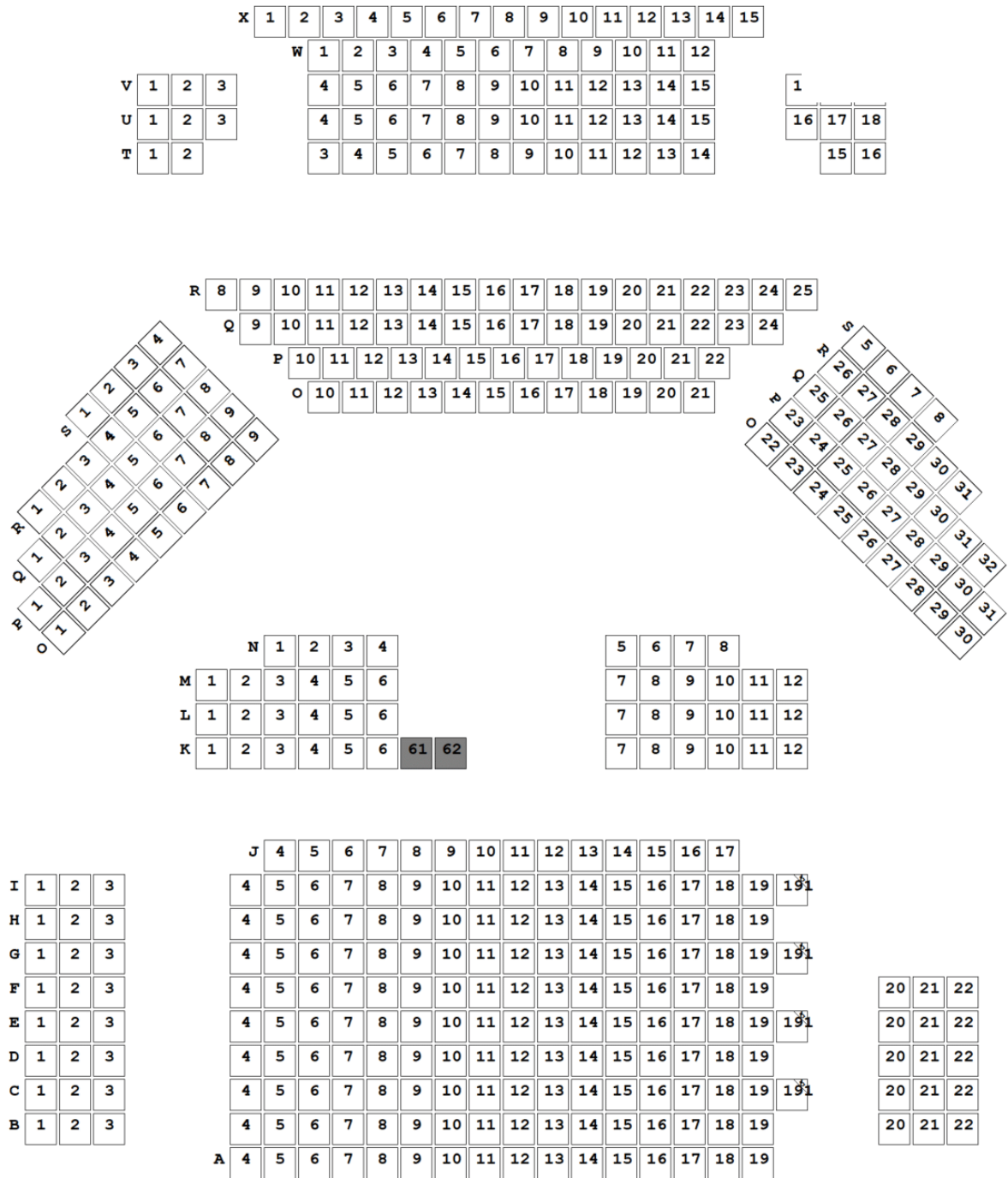

Appendix B: Stage Plan

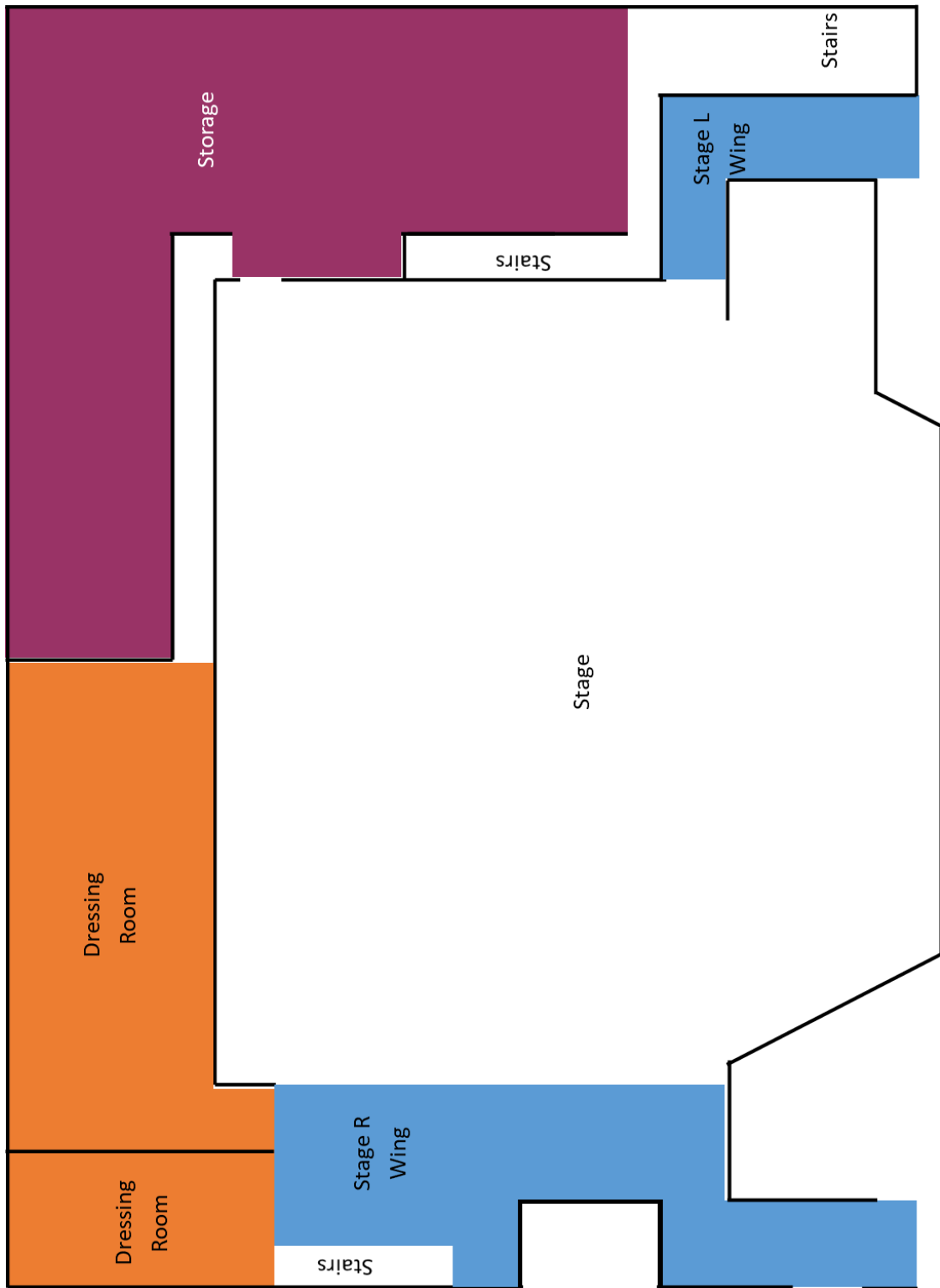

Not to Scale

Manylebau Technegol | Technical Specifications

Appendix C: Dressing Room Pictures



Dressing Room 1



Dressing Room 2

Manylebau Technegol | Technical Specifications



Lesser Hall (can be added for larger casts)